

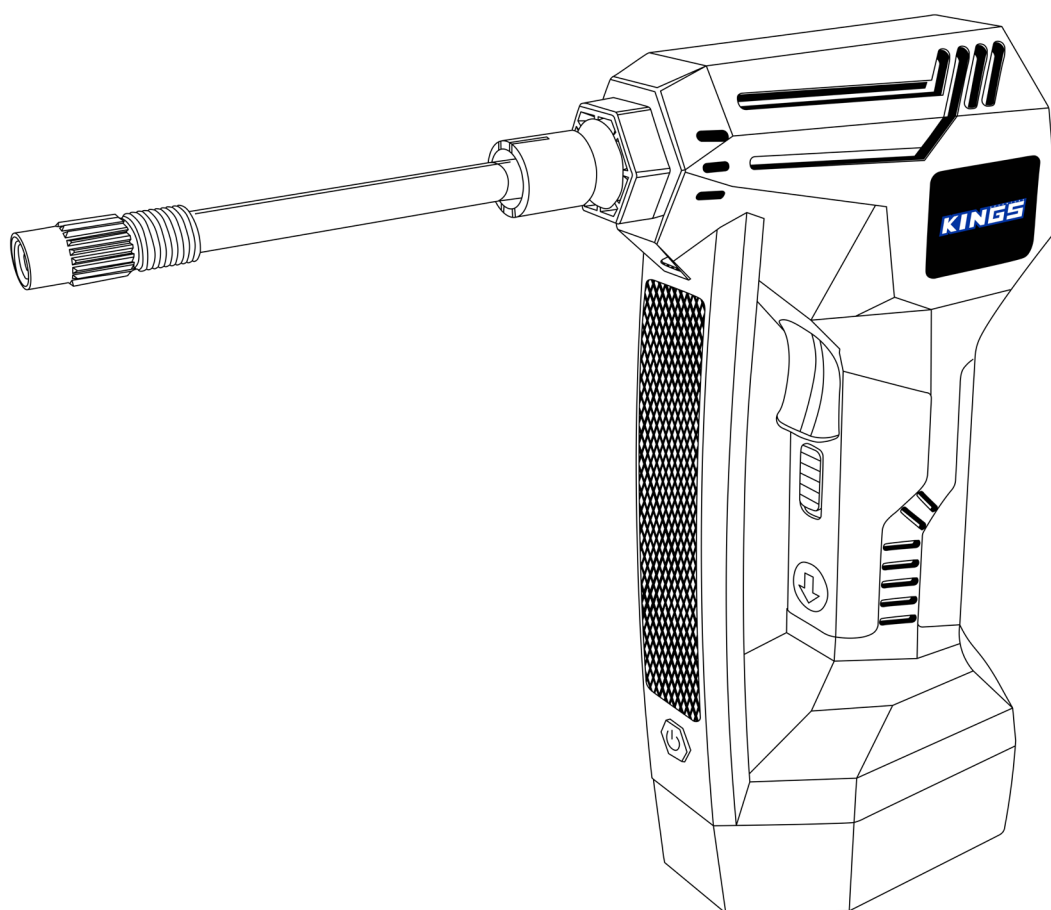

# LITHIUM AIR COMPRESSOR USER MANUAL

AKAC-LITAIR\_01



V1.2

**PLEASE READ AND UNDERSTAND THIS MANUAL  
COMPLETELY BEFORE USING THIS PRODUCT.**

# SAFETY INFORMATION

## READ ENTIRE MANUAL BEFORE USE, SAVE THESE INSTRUCTIONS

**WARNING** Read all the safety warnings and all instructions. Failure to follow all warnings and instructions may result in electric shock, fire and/or serious injury.

- Do not operate air compressor in explosive atmospheres, such as in the presence of flammable liquids, gases or dust.
- Keep air compressor away from children.
- The air compressor plug must match the power outlet. Never modify the plug in any way. Do not use any adapter plugs with earthed (grounded) power tools.
- Do not expose the air compressor to rain or wet conditions. Water entering the air compressor will increase the risk of electric shock.
- Do not abuse the cord. Never use the cord for carrying, pulling or unplugging the air compressor. Keep cord away from heat, oil, sharp edges or moving parts. Damaged or entangled cords increase the risk of electric shock.
- Stay alert, watch what you are doing and use common sense when operating the air compressor. Do not use the air compressor while you are under the influence of drugs, alcohol or medication.
- Recharge only with the charger specified by the manufacturer.
- Only use the air compressor with the supplied battery pack.
- When battery pack is not in use, keep it away from other metal objects. Shorting the battery terminals together may cause burn or fire.

## **GENERAL SAFETY MEASURE AND PRECAUTIONS THAT APPLY TO THE USE OF THE AIR COMPRESSOR**

Safe operation of the air compressor requires that you read the instructions and safety precautions carefully and follow all instructions before using the air compressor.

### **FOR HOUSEHOLD USE ONLY**

1. The air compressor is designed for occasional use. Inflation over long period will overheat the air compressor and may cause damage.
2. The air compressor should not operate for more than 15 minutes at a time, after which it must be switched off and set aside to cool for at least 15 minutes before restarting.
3. If the air compressor emits abnormal sounds or overheats, turn it off immediately and let it cool off for a minimum of 30 minutes.
4. Inspect air compressor before use. If cracked, broken or damaged parts are found, do not use.
5. Incorrect use of the air compressor may result in personal injury and/or property damage.
6. Never expose the air compressor to rain, frost or temperatures above 50 degrees
7. Never use the air compressor near flammable fluids or gases.
8. Protect yourself against electric shock. Avoid physical contact with the grounded surfaces such as pipes, radiator, electric stoves, refrigerators, etc.
9. Never allow children to connect or disconnect the air compressor to/from power sources. Never leave children unattended with the air compressor and never allow them to play with the accessories.
10. Never allow anyone to pump air into mouth, ears, nose, etc of people or animals. The air compressor is not a toy.
11. Store the air compressor in a secure location. If the air compressor is going to be unused for a long period of time, it should be store in a dry place inaccessible to children.
12. Keep the air compressor clean to maintain maximum output and safety. Examine the plug, charger and cable pack on a regular basis and have them repaired by a qualified technician if they are damaged.
13. Warning! For your own safety, you should only use accessories and parts specified in the instructions. Use of the accessories and other parts that are not mentioned in the instructions may entail and increase risk for the user of the air compressor.
14. This appliance is not intended by persons (including children) with reduced physical, sensory or mental capabilities, or lack of experience and knowledge, unless they have been given supervision or concerning use of the appliance by a person responsible for their safety.

**INCLUDED IN THE BOX**



Attachment 1



Attachment 2



Charger



12V Adapter



Bag



Lithium battery

# LITHIUM AIR COMPRESSOR SPECIFICATIONS

Voltage	12 V
Power	120 W
Battery Capacity	1500 mAh
Maximum Current	10 A
Maximum Pressure	150 PSI
Pressure Gauge Accuracy	-1/+1.5 PSI
Pressure Units	PSI/BAR/KPA
Hose Length	15 cm
Cord Length	3.5 m

# OPERATING INSTRUCTIONS

## CHARGING

1. Plug 240V Charger into a suitable the mains socket
2. Insert the pin of the charger into the housing of the 12V Lithium Battery
3. The battery will take 3-5 hours to charge.

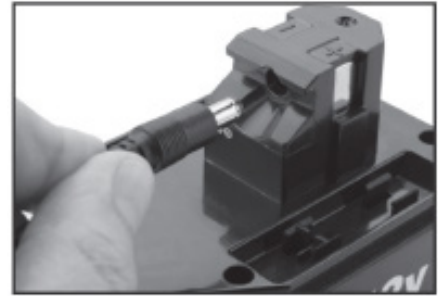

## INFLATING TYRES

1. Loosen the attachment lock approximately 3 rotations counter-clockwise (see Fig 3). Do not remove lock completely.
2. IMPORTANT: Insert the air hose with threaded connector into the attachment until it can go no further. (See Fig 4).
3. Tighten attachment lock clockwise until hand tight.
4. Press the Power button below the LCD display to turn on (See fig 5).
5. Then choose desired pressure format (PSI, BAR, KPA) press the power button continuously until desired format displays.
6. Screw the threaded connector onto tyre's valve stem quickly. When connected, the gauge will show current tyre pressure.
7. Press "+" or "-" to set desired pressure level. Once set, wait a few seconds until current tyre pressure displays. NOTE: Always check and follow the manufacture's recommended pressure, usually located on the door jamb of the vehicle.
8. Being sure trigger lock is in unlock position, press the trigger.
9. The air compressor will begin to inflate the tyre to the set pressure level and then shut off automatically when reached.
10. When done, press the trigger once to turn off and slide the trigger lock to the lock position.
11. Remove the thread connector from the tyre quickly and replace valve stem cap on tyre, if required. **WARNING:** Connector may be hot. Use caution when removing.

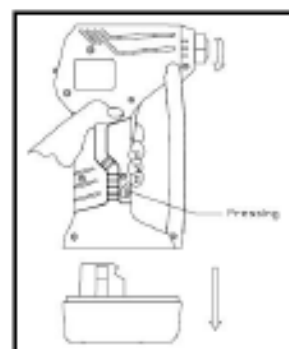
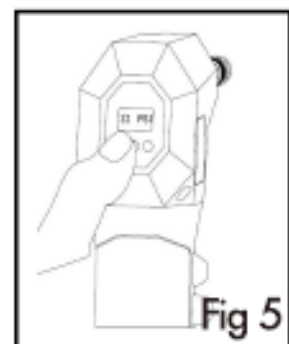
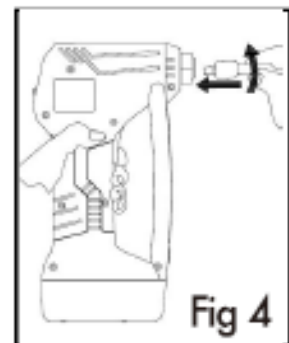
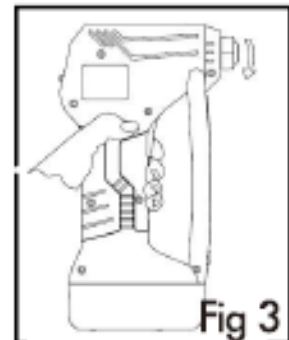

**NOTE:** To avoid over-inflation of tyres, please check the recommended tyre pressure in the vehicle's owner's manual.

## WARNING

The LCD display must be turned on before operating air compressor. Please read and understand the instructions provided in the manual prior to operation.

Use a separate pressure gauge for more accurate reading.

12. Emergency lamp by the combination of 18 LED's. Turn on the button, LED will shine white, press again it will flash red, press again and it will flash red SOS.
13. Accessory 1 is suitable for inflating balls and Accessory 2 is suitable for inflating balloons and air cushions.

## INFLATING ITEMS WITH ADDITIONAL TIPS

1. Loosen the attachment lock approximately 3 rotations counter-clockwise (See Fig 6). Do not remove lock completely.
2. **IMPORTANT:** Insert the tip into the attachment lock. Press in firmly while screwing in clockwise until it can go no further (See Fig 7).
3. Tighten attachment lock clockwise until hand tight.
4. Press the power button below the LCD display to turn on. (See Fig 8)
5. **NOTE:** After 30 Seconds of inactivity, the digital tyre gauge will turn off automatically to conserve energy.
6. Insert the tip adapter into the inflatable object and push trigger.
7. Allow the air compressor to run until fully inflated.
8. Remove tip adapter from the inflated object quickly and replace valve cover if required.

**NOTE:** The pressure gauge will only provide an estimated reading.

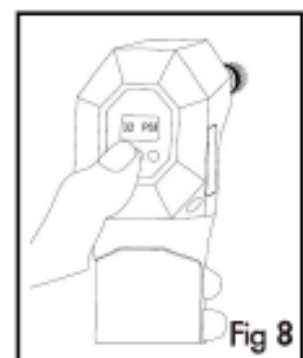
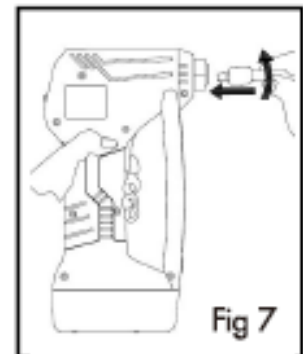
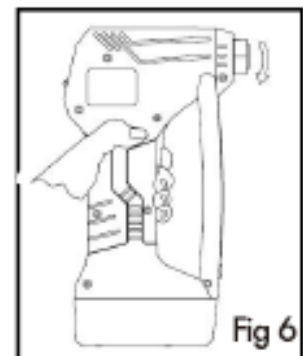

# 12 MONTH LIMITED WARRANTY

## WARRANTY PERIOD:

Full 12 month warranty from date of purchase against all manufacturing defects.

---

## WHAT DOES THE WARRANTY COVER?

Under normal usage conditions, this warranty covers:

- a. Any defect in design or manufacture which results in the product failing to perform substantially as described in authorised advertising or literature.
- b. We will either repair or replace the product at our discretion providing that the fault is found to have been caused by a design or manufacturing defect and not misuse or tampering.

Our goods come with guarantees that cannot be excluded under the Australian Consumer Law. You are entitled to a replacement or refund for a major failure and for compensation for any other reasonably foreseeable loss or damage. You are also entitled to have the goods repaired or replaced if the goods fail to be of acceptable quality and the failure does not amount to a major failure. The benefits provided to you as the consumer by this warranty are in addition to other rights and remedies available to you under the law.

---

## THE WARRANTY DOES NOT COVER:

- a. Any damage resulting from improper use
  - b. Faulty installation or modification made during installation
  - c. The cost of removing and reinstalling the product
  - d. Travel and /or other expenses due to customer's remote location
  - e. Transport charges and damage in transit. It is your responsibility to deliver and pick up your product, including any costs associated with the postage of your repair or replacement product. If you do freight your product we recommend that you insure against loss or damage.
  - f. Any loss directly or indirectly associated with the product failing to operate.
  - g. Damage caused by mould, insects, animals, misuse, incorrect operation, adverse weather, accidents and fair wear and tear
- 

TO MAKE A CLAIM, PLEASE ENSURE YOU RETAIN YOUR SALES RECEIPT OF PURCHASE

# 1800 88 39 64



OUTDOOR SUPACENTRE PTY LTD  
2 Stanley St Silverwater NSW, 2128  
PHONE: 1800 88 39 64  
[www.4wdsupacentre.com.au](http://www.4wdsupacentre.com.au)