

# Fixed Solar Panel Kit

## **USER MANUAL**

PLEASE READ AND UNDERSTAND THIS MANUAL COMPLETELY BEFORE USING & INSTALLING THE FIXED SOLAR PANEL KIT.

## Warnings

- Ensure all the bolts are firm and will not vibrate loose.
- Check all nuts and bolts frequently, making sure they are tight and in good condition
- Take care when manoeuvring & installing the Solar Panel as to not damage the unit
- Never connect the Solar Panel directly (without a controller) to a battery or other load.

## Included in the Kit:

#	ITEM:	QTY:
1	110W Monocrystalline Solar Panel	1
2	Z-Shaped Bracket	4
3	Aluminium Support Plate	4
4	M8*16 Bolt	4
5	M8 Nylon Lock Nut	4
6	M8 Washer (Form A)	12
7	M8*25 Bolt	8
8	M8 Spring Washer	8
9	M8 Washer (Form C)	4



## Installation:

### CONNECTING THE 4 Z-SHAPED BRACKETS TO THE SOLAR PANEL

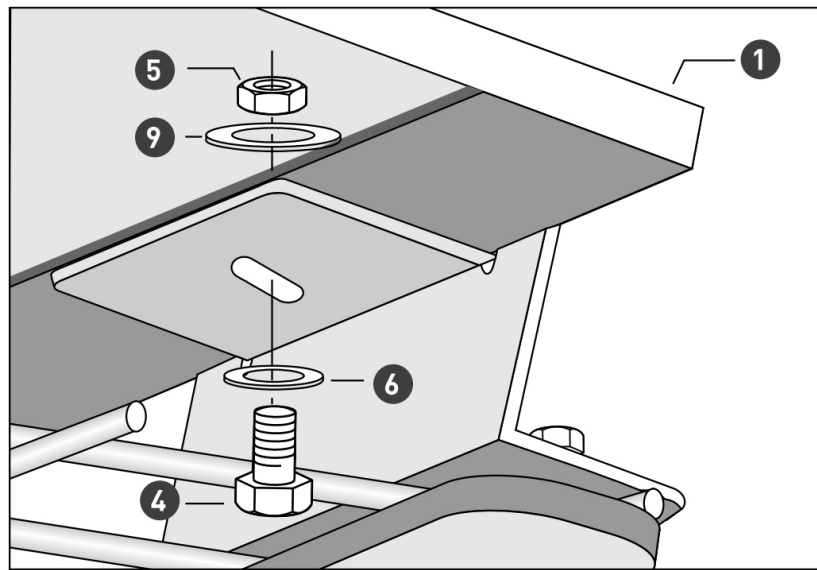

Figure 1

1. Align the Z-shaped bracket **2** with the solar panels holes.
2. Put a washer **6** on the M8\*16 bolt **4** and thread it through the Z- bracket and the solar panel.  
Then put another washer **9** onto the bolt and finally a nylon lock nut **5** .
3. Tighten making sure the Z-brackets supports are pressed firmly against the outside of the solar panel.
4. Repeat 1 to 3 for each of the four Z-brackets.

**MOUNTING THE SOLAR PANEL ONTO THE ROOF RACK.**

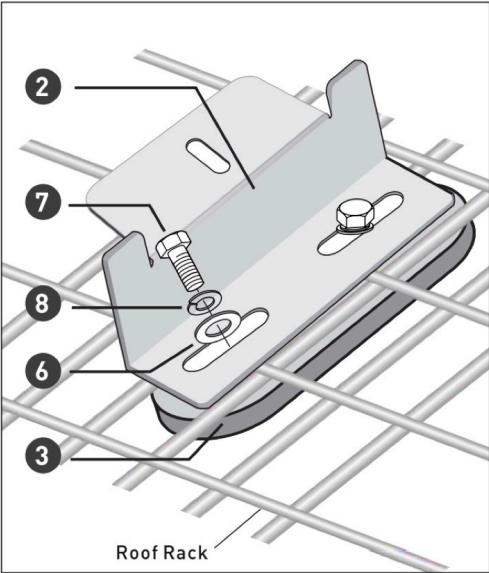

Figure 2

5. With all four brackets installed, position the solar panel onto your roof rack.
6. Line up the Z-bracket **2** with the support plate **3**, ensuring that there is at least 2 parallel wires running between the bolts.
7. Put a split washer **8**, then a washer **6** onto the M8\*25 bolt **7** then screw it into the support plate **3**.
8. Repeat this to secure the solar panel at all four points.

Maximum Power (Pmax):	110W
Maximum Power Voltage (Vmp):	18.2V
Maximum Power Current (Imp):	6.04A
Open Circuit Voltage:	22.3V
Short Circuit Current:	6.49A
Maximum System Voltage:	1000V DC
Operating:	-40°C to 85°C
Weight:	7.85kg
Dimensions (mm):	1010 x 676 x 355

# 12 MONTH LIMITED WARRANTY

## WARRANTY PERIOD:

Full 12 month warranty from date of purchase against all manufacturing defects.

---

## WHAT DOES THE WARRANTY COVER?

Under normal usage conditions, this warranty covers:

- a. Any defect in design or manufacture which results in the product failing to perform substantially as described in authorised advertising or literature.
- b. We will either repair or replace the product at our discretion providing that the fault is found to have been caused by a design or manufacturing defect and not misuse or tampering.

Our goods come with guarantees that cannot be excluded under the Australian Consumer Law. You are entitled to a replacement or refund for a major failure and for compensation for any other reasonably foreseeable loss or damage. You are also entitled to have the goods repaired or replaced if the goods fail to be of acceptable quality and the failure does not amount to a major failure. The benefits provided to you as the consumer by this warranty are in addition to other rights and remedies available to you under the law.

---

## THE WARRANTY DOES NOT COVER:

- a. Any damage resulting from improper use
  - b. Faulty installation or modification made during installation
  - c. The cost of removing and reinstalling the product
  - d. Travel and /or other expenses due to customer's remote location
  - e. Transport charges and damage in transit. It is your responsibility to deliver and pick up your product, including any costs associated with the postage of your repair or replacement product. If you do freight your product we recommend that you insure against loss or damage.
  - f. Any loss directly or indirectly associated with the product failing to operate.
  - g. Damage caused by mould, insects, animals, misuse, incorrect operation, adverse weather, accidents and fair wear and tear
- 

TO MAKE A CLAIM, PLEASE ENSURE YOU RETAIN YOUR SALES RECEIPT OF PURCHASE

# CALL 1800 88 39 64



OUTDOOR SUPACENTRE PTY LTD  
2 Stanley St Silverwater NSW, 2128  
PHONE: 1800 88 39 64  
[www.4wdsupacentre.com.au](http://www.4wdsupacentre.com.au)

